

Plastic Bevel Tool for pipes  $\varnothing 16$ ,  $\varnothing 18$ ,  $\varnothing 20$

## TECHNICAL DATA BEVEL TOOL 12000121

Inner diameter gauge and bevel tool for PERT-AL-PERT and PEXb-AL-PE multilayer pipes  
 Suitable for multilayer pipes  $\varnothing 16$ ,  $\varnothing 18$  and  $\varnothing 20$   
 Material: Plastic  
 Color: black



## PURPOSE OF THE BEVEL TOOL



Normally, while cutting the multilayer pipe, the pipe is deformed. The section we made when cutting is elliptical, due to the hardness that the intermediate layer of aluminum offers to the multilayer pipe, which cause a problem when assembling the fittings, since it costs much more to insert these fittings to the pipe.

For this, the main function of the gauge is to correct the internal diameter of the pipe, so that it is round, has the expected size and makes it easier for us to assemble the desired multilayer fittings. As an added aid, the gauge has a bevel in each diameter, to countersink the pipe both inside and outside, making the assembly of multilayer fittings much easier.

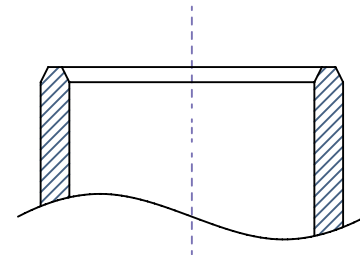

## USER MANUAL

- ① Insert the bevel tool into the pipe up to the stop section corresponding to the diameter of the pipe (16, 18 or 20).
- ② Turn it clockwise and check if the beveling has been done correctly.
- ② Insert the desired fitting of the same size into the pipe.